

Marshall

An Overview for El Dorado Hills Area Planning Advisory Committee



Who we are



- Marshall was built by the community it serves
- Today we are
 - 111-bed general acute care hospital in Placerville
 - 16 outpatient clinics – primary and specialty care in Placerville, Georgetown, Cameron Park and El Dorado Hills
 - Level III Trauma Center
 - Marshall Cancer Center, an Affiliate of UC Davis Health
 - ~1,600 employees and 150 practitioners

Yesterday...



Today...



And tomorrow!



Marshall commits to creating a community where everyone can achieve their highest desired state of health and well-being.

Our Plans for El Dorado Hills



- 25,000 SF clinic space on first floor
 1. Primary care
 2. Orthopedic clinic
 3. Physical therapy and rehabilitation
 4. Same-day orthopedic care
- Other specialties may rotate in
- Tenant improvements to commence soon
- Estimated opening Spring of 2025

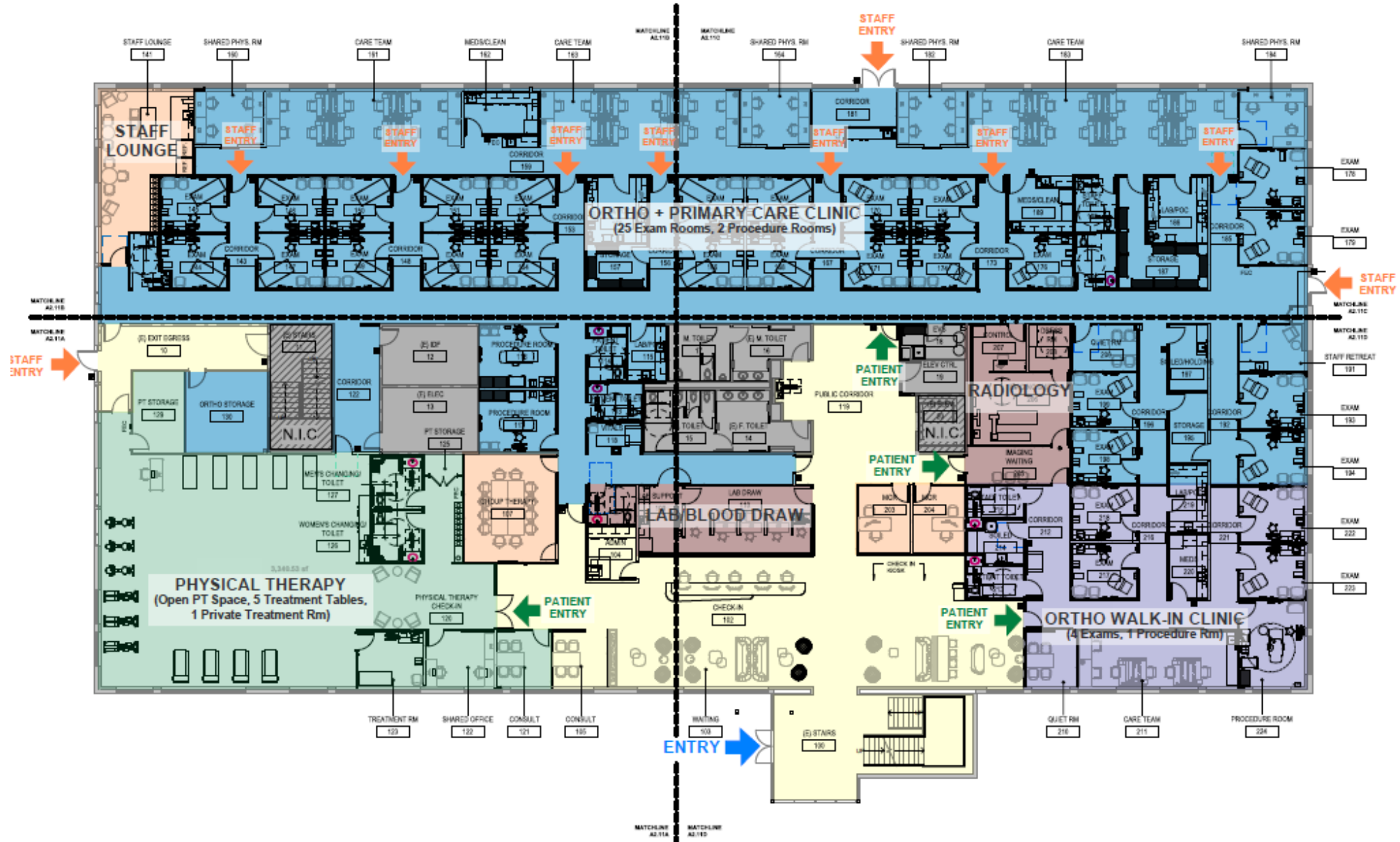

What about the second floor?

- Convening with strategic partners
- Board and executive leadership direction
- El Dorado Hills Healthcare Advisory Committee recommendations
- Financing is a challenge...

Discussion



Thank you!